



# LAW ENFORCEMENT

SPECIALTY LOCKERS





# TACTICAL

## LOCKERS

We **have** designed and produced a series of tactical lockers configured to conform to the law enforcement industry requirements.

[www.ALBplus.ca](http://www.ALBplus.ca)



Tactical locker with single or double doors and 9" deep oak top bench drawer.

### Optional

Base drawers are lockable when main door is closed

All welded tactical lockers are fabricated with piano hinged and double pan doors.

- With or without bench
- Locks are available on interior and exterior doors

Our lockers conform  
to the law enforcement  
industry requirements



Lockable  
compartment

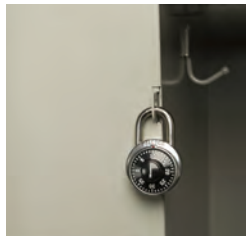

Hasp for padlock



Ajustable mirror



Coat bar



hooks

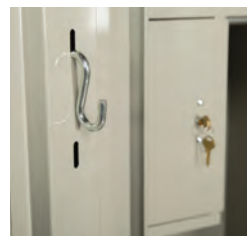

Belt holder

### Optional components:

- Belt hook
- Adjustable shelves
- Hooks
- Coat bar
- Lockable compartment
- Oak top drawer 12"
- Boot tray
- Note book pocket
- Adjustable mirror
- Interior drawers
- Vest drying rack
- Electric receptacle
- Airflow style



## Tactical lockers

We have developed this new addition to our collection. A tactical double-door and double-drawer in response to your specific needs.

Custom components  
for every task force need



Boot tray



Coat bar with  
separation



Drawer with vest  
drying rack

# EVIDENCE

LOCKERS



We have  
been fabricating  
all-welded lockers  
and filing cabinets  
for over 40 years

Our experience has proven that  
our evidence lockers are  
designed to maximise the security  
of evidence and are built within  
the highest quality of metal  
lockers in the industry.

[www.ALBplus.ca](http://www.ALBplus.ca)

## Different models for different needs

Available in pass-thru and non pass-thru models,  
in multiple sizes with maximum security, each with  
a five year warranty.

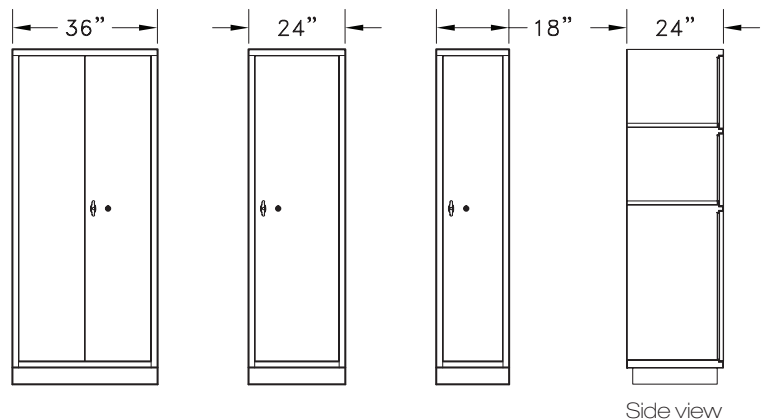

*See all configurations on page 6*

# EVIDENCE

## LOCKERS

Available  
configurations

### Door dimensions:

(36" x 78" basic configuration)

- |                      |                       |
|----------------------|-----------------------|
| A: 14-3/4" x 74-3/4" | F: 9-3/4" x 17-3/4"   |
| B: 14-3/4" x 36-3/4" | G: 6-1/2" x 55-3/4"   |
| C: 14-3/4" x 24-1/8" | H: 6-1/2" x 8-1/4"    |
| D: 14-3/4" x 17-3/4" | BB: 32-3/4" x 36-3/4" |
| E: 14-3/4" x 8-1/4"  | GG: 14-3/4" x 55-3/4" |

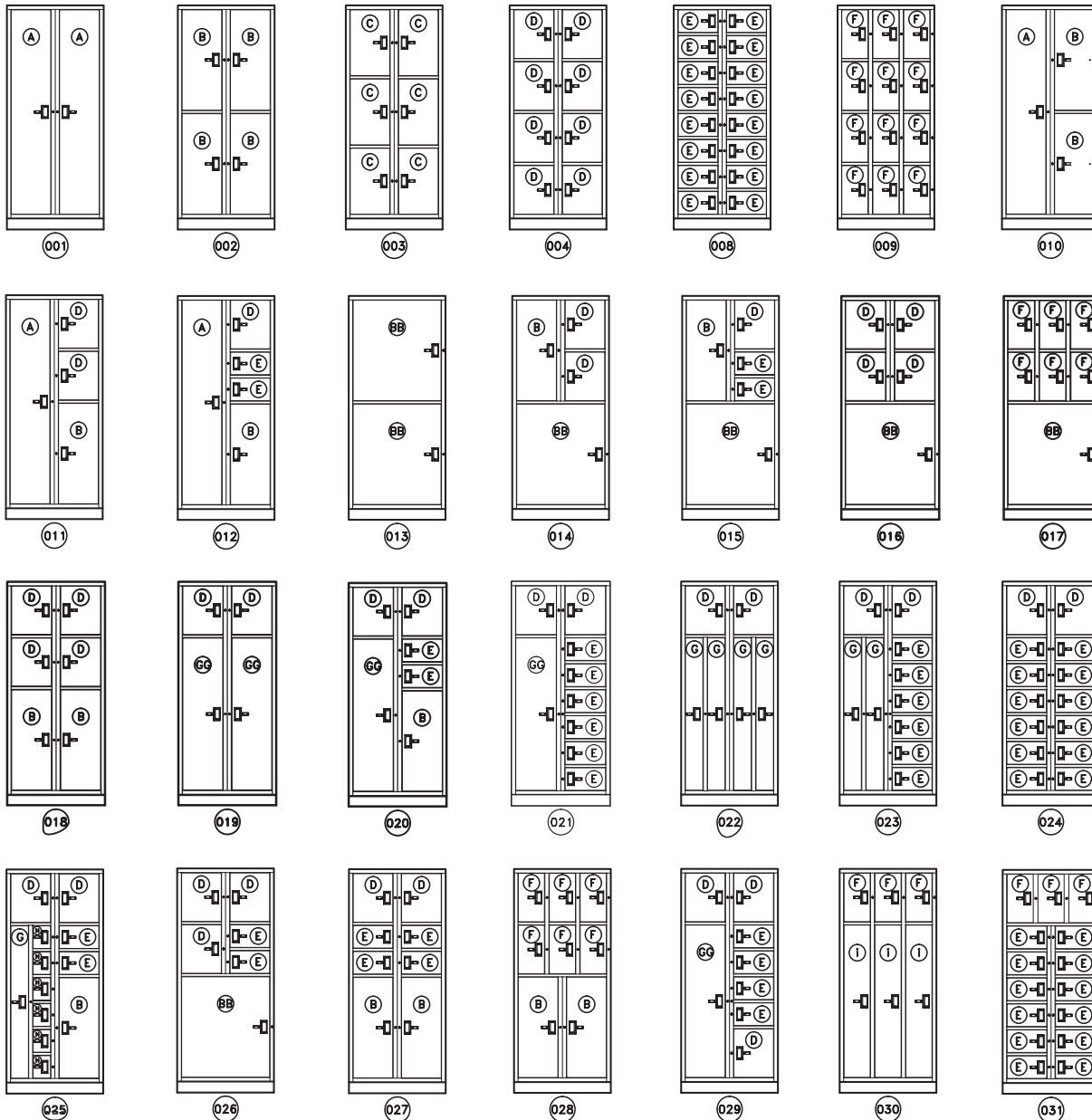
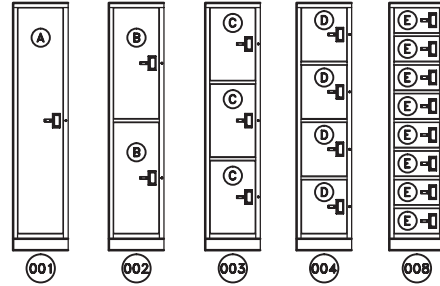



Our metal Evidence lockers are built for durability and efficiency. They provide security of stored items.

FRONT VIEW



Package deposited and retrieved by responsible officer.

## Security

Protection and integrity in both our pass-thru and non pass-thru.



REAR VIEW



Rear access for collection of evidence



# GUN & RIFLE

## LOCKERS

Welded gun & rifle  
lockers for well  
organized space  
and efficient  
storage



All our lockers are available in custom sizes, colors and configurations.



Gun compartment



Bullets and spray compartments



Gun locker



All-welded, vented-door lockers for guns and rifles



## BULLETPROOF VEST

### LOCKERS

To securely store  
bulletproof vest  
in multiple vented  
drawer locker.

This 3 drawer locker can  
be stacked up to 4 high.

Size: 36 x 36 x 20½"



6265, Notre-Dame East, Montreal, Quebec H1N 2E9

1-514-593-4548

[www.ALBplus.ca](http://www.ALBplus.ca)